

PLANTA BAJA - (BLOQUE 3)

VIVIENDA TIPO A (T.9)

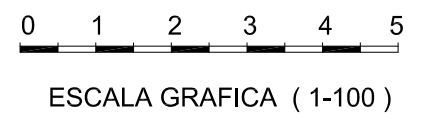
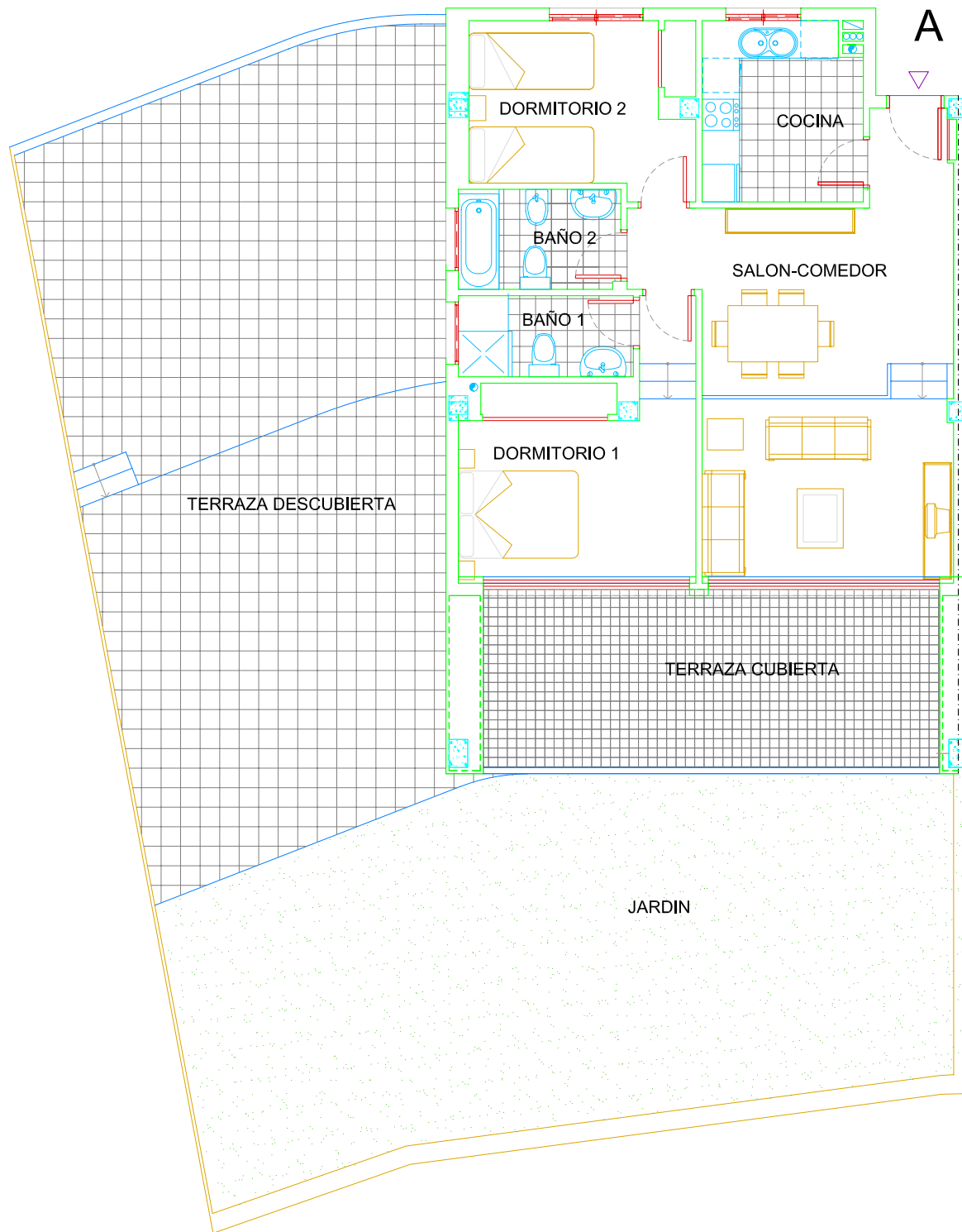

SUPERFICIES TIPO A (T.9)

SUP. UTIL	65.78 m2
SUP. CONSTRUIDA CERRADA	74.98 m2
TERRAZA CUBIERTA (100%)	20.80 m2
P.P.ELEM.COMUNES	5.78 m2
JARDIN	66.08 m2
TERRAZA DESCUBIERTA	69.02 m2

